

NORTH PART OF SITE  
UNITS 2 & 3  
SCALE 1:250

**KEY**

- Existing tree
- Existing Bushes
- New tree (Select Standard to BS 3936) - species to be approved.
- New low level Shrubs - species to be approved.
- Existing trees to be removed
- Application Boundary

**Schedule of Areas**  
Magna 34

Unit	Area (m <sup>2</sup> )	Area (sq ft)
1A	317	3412
1B	241	2594
1C	303	3260
1D	301	3240
<b>Total Area</b>	<b>1160</b>	<b>12406</b>
2	443	4768
<b>Total Area</b>	<b>443</b>	<b>4768</b>
3A	305	3283
3B	234	2519
3C	234	2519
3D	235	2530
3E	277	2982
3F	276	2971
3G	277	2982
3H	277	2982
<b>Total Area</b>	<b>2144</b>	<b>22757</b>

All Units	Area (m <sup>2</sup> )	Area (sq ft)
<b>Total Area</b>	<b>3717</b>	<b>40011</b>

**LEGEND**

Site 1 Area - 0.320 ha (0.791 acres)  
 Site 2 - 0.113 ha (0.280 acres)  
 Site 3 - 0.549 ha (1.357 acres)  
 Site Area Total - 0.982 ha (2.428 acres)

**Car Parking**

18 No. spaces for Units 1 to 1D (including 4 Dis. spaces)  
 10 No. spaces for Unit 2 (including 2 Dis. spaces)  
 40 No. spaces for Unit 3A to 3H (including 8 Dis. spaces)  
 68 No. total spaces

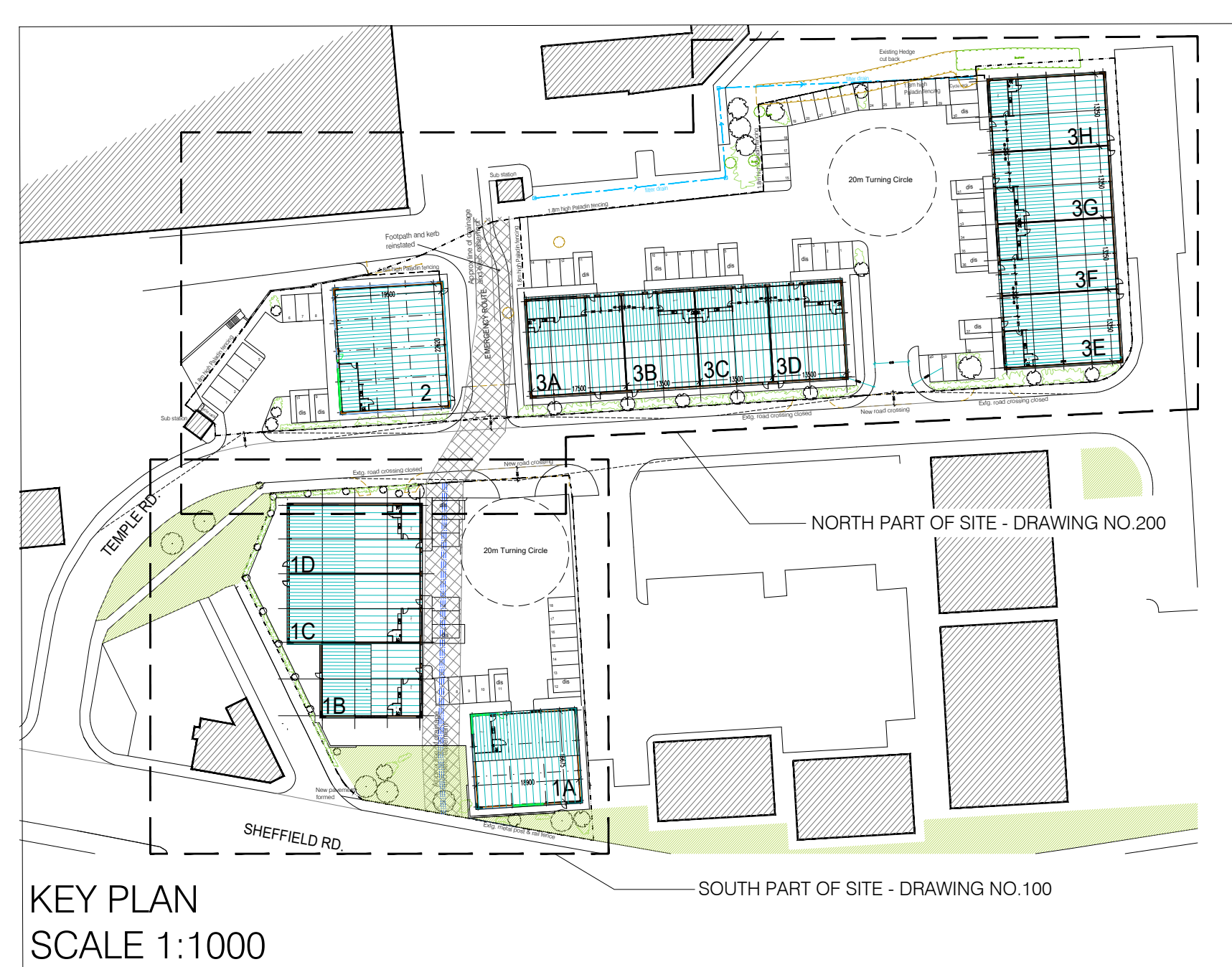

KEY PLAN  
SCALE 1:1000

PROPOSED SITE LAYOUT  
NORTH PART OF SITE - UNITS 2 & 3